

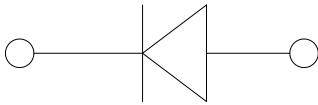

General Purpose Rectifier

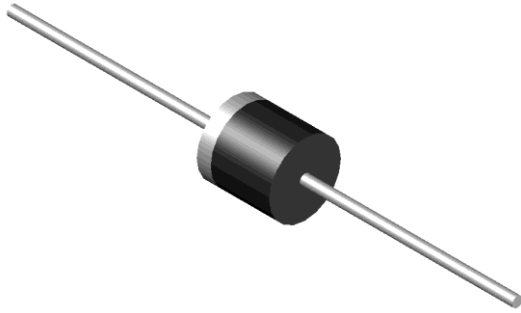

Features

- High efficiency
- High current capability
- High reliability
- High surge current capability
- Low power loss
- Glass passivated chip junction
- Solder dip 275 °C max. 7 s, per JESD 22-B106

Mechanical Data

- **Package:** R-6
Molding compound meets UL 94 V-0 flammability rating, RoHS-compliant
- **Terminals:** Tin plated leads, solderable per J-STD-002 and JESD22-B102
- **Polarity:** Color band denotes cathode end

■ Maximum Ratings (Ta=25°C Unless otherwise specified)

PARAMETER	SYMBOL	UNIT	P6A05G	P6A1G	P6A2G	P6A4G	P6A6G	P6A8G	P6A10G
Device marking code			P6A05G	P6A1G	P6A2G	P6A4G	P6A6G	P6A8G	P6A10G
Repetitive Peak Reverse Voltage	VRRM	V	50	100	200	400	600	800	1000
Average Forward Current @60Hz sine wave, Resistance load, Ta =75°C	IF(AV)	A	6.0						
Forward Surge Current (Non-repetitive) @60Hz Half-sine wave, 1 cycle, Ta=25°C	IFSM	A	200						
Storage Temperature	Tstg	°C	-55 ~+150						
Junction Temperature	Tj	°C	-55~+150						

■ Electrical Characteristics (Ta=25°C Unless otherwise specified)

PARAMETER	SYMBOL	UNIT	TEST CONDITIONS	P6A05G	P6A1G	P6A2G	P6A4G	P6A6G	P6A8G	P6A10G
Maximum instantaneous forward voltage drop per diode	V _{FM}	V	IFM=6.0A	1.1						
Maximum DC reverse current at rated DC blocking voltage per diode	I _{RRM1}	μA	Ta=25°C	2.5						
	I _{RRM2}		Ta=100°C	50						
Typical junction capacitance	Cj	pF	Measured at 1MHZ and Applied Reverse Voltage of 4.0 V.D.C.	50						

■ Thermal Characteristics (Ta=25°C Unless otherwise specified)

PARAMETER	SYMBOL	UNIT	P6A05G	P6A1G	P6A2G	P6A4G	P6A6G	P6A8G	P6A10G
Thermal Resistance(Typical)	R _{θJ-A}	°C/W	12						



P6A05G THRU P6A10G

Ordering Information (Example)

PREFERRED P/N	PACKAGE CODE	UNIT WEIGHT(g)	MINIMUM PACKAGE(pcs)	INNER BOX QUANTITY(pcs)	OUTER CARTON QUANTITY(pcs)	DELIVERY MODE
P6A05G-P6A10G	D1	Approximate 1.95	500	500	5000	Tape
P6A05G-P6A10G	C1	Approximate 1.95	100	100	5000	Bulk

Characteristics (Typical)

FIG.1: I_o-T_a Curve

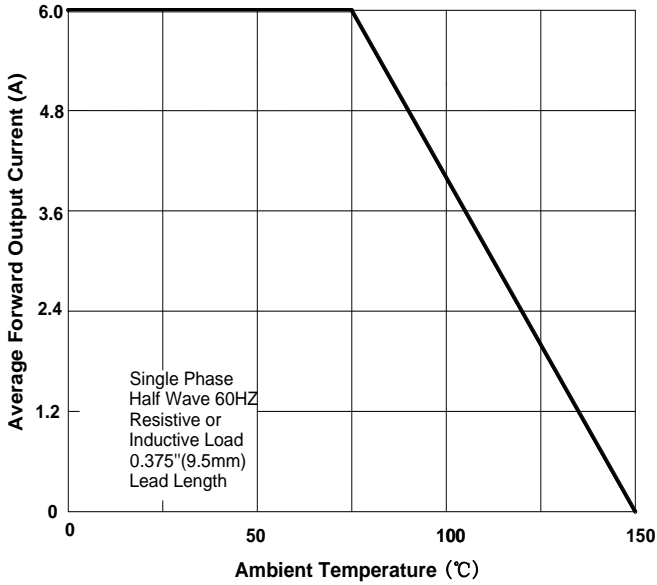

FIG.2: Forward Surge Current Capability

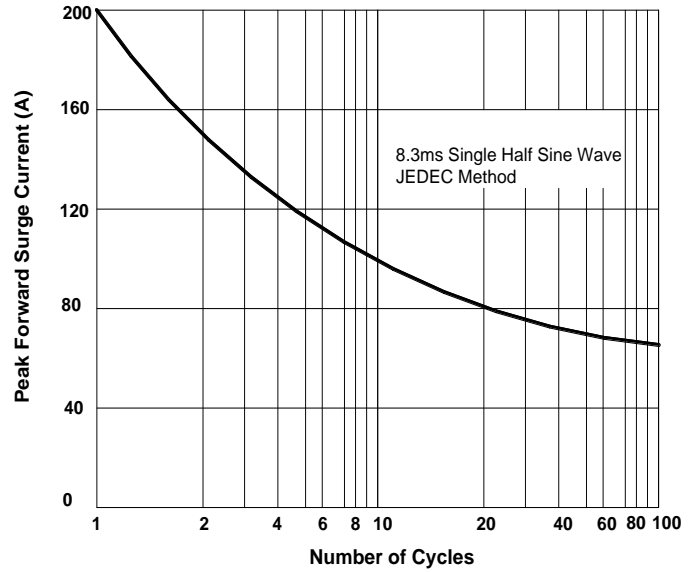

FIG.3: Forward Voltage

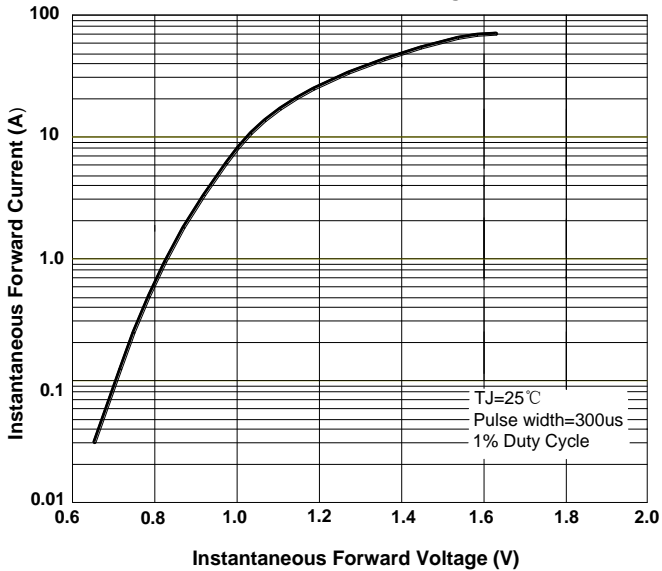
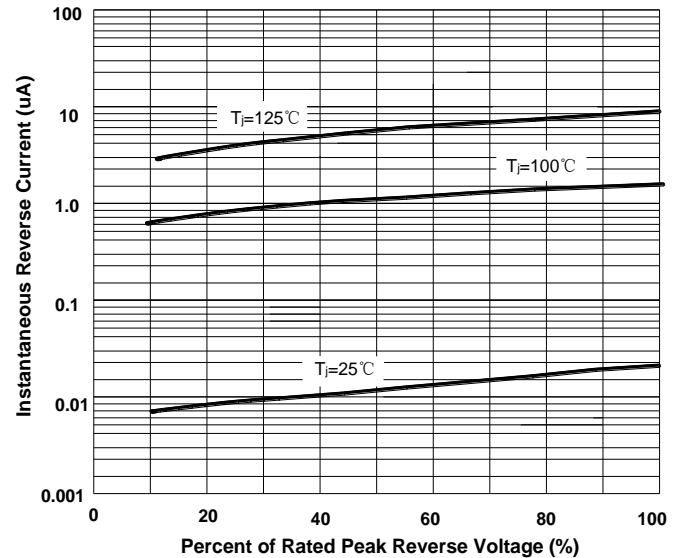

FIG.4: Typical Reverse Characteristics





P6A05G THRU P6A10G

■ Outline Dimensions

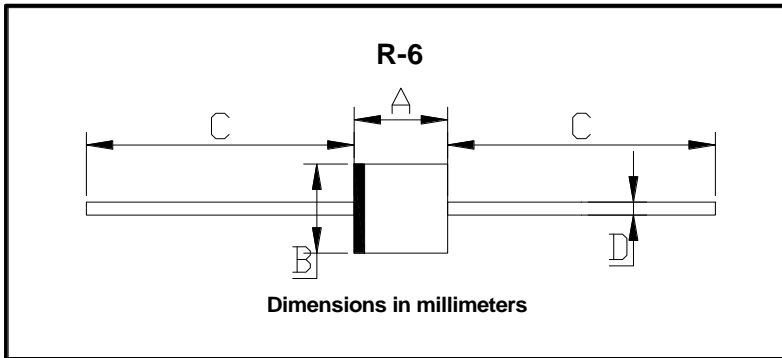

R-6		
Dim	Min	Max
A	8.60	9.10
B	8.60	9.10
C	25.4	/
D	1.20	1.32



P6A05G THRU P6A10G

Disclaimer

The information presented in this document is for reference only. Yangzhou Yangjie Electronic Technology Co., Ltd. reserves the right to make changes without notice for the specification of the products displayed herein to improve reliability, function or design or otherwise.

The product listed herein is designed to be used with ordinary electronic equipment or devices, and not designed to be used with equipment or devices which require high level of reliability and the malfunction of which would directly endanger human life (such as medical instruments, transportation equipment, aerospace machinery, nuclear-reactor controllers, fuel controllers and other safety devices), Yangjie or anyone on its behalf, assumes no responsibility or liability for any damages resulting from such improper use of sale.

This publication supersedes & replaces all information previously supplied. For additional information, please visit our website [http:// www.21yangjie.com](http://www.21yangjie.com) , or consult your nearest Yangjie's sales office for further assistance.