

TACT SWITCH DTS(G)MW-6 SERIES

6x6 Gull-Wing SMT Washable Type

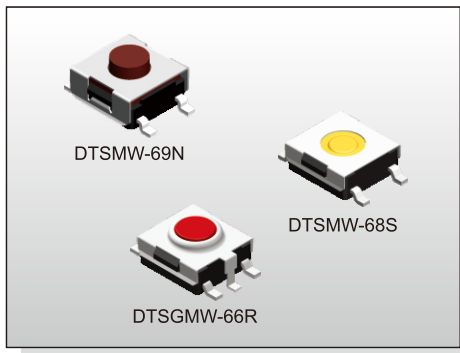

FEATURES

- ※Sealed
- ※Reflow solderable
- ※Dust proof with high reliability

APPLICATION

- ※Audio, OA equipment
- ※Instrumentation, Communication
- ※White goods

SPECIFICATION

Contact Rating	50mA, 12V DC
Contact Resistance	100mΩ max.
Insulation Resistance	100MΩ min. 500V DC
Dielectric Strength	250V AC/1 minute
Operating Force	160±50gf, Brown(N) 66/677 160±50gf, Silver(S) 68 180±50gf, Brown(N) 69/67/65/64 260±70gf, Red(R) 69/67/66/65/64 360±90gf, Transparent(T) 69/67/65/677
Travel	0.25mm 68S/66N/66R/677 0.45mm (69/67N,R)/(65/64N,R,T) 0.6mm 69/67T
Operating Life	100,000 cycles min. for 68/66/677 500,000 cycles min. for 69/67/65/64
Operating Temp.	-25°C ~ +70°C
Storage Temp.	-30°C ~ +80°C

HOW TO ORDER

D T S **W - 6** - -

- M=S.M.T.
- GM=S.M.T. & With Ground Pin (66 Only)
- Washable
- Package: B=Tube, T/R=Tape & Reel
- V=RoHS & Lead Free Solderable
- Q=Halogen Free

Operating Force:
 N=Brown, 160gf(66N, 677N)
 180gf(69N, 67N, 65N, 64N)
 S=Silver, 160gf(68S)
 R=Red, 260gf(69R, 67R, 66R, 65R, 64R)
 T=Transparent, 360gf(69T, 67T, 65T, 677T)

Dimension H:
 4=4.50mm (N, R)
 5=3.50mm (N, R, T)
 6=3.10mm (N, R)
 7=5.20mm (N, R, T)
 77=7.30mm (N, T)
 8=2.30mm (S)
 9=3.80mm (N, R, T)

CIRCUIT

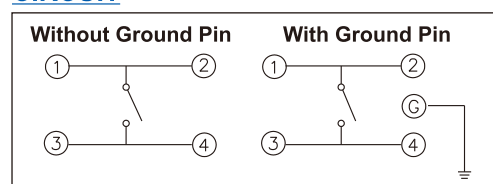

PACKAGE

- <Tube>
75 pcs
- <Tape & Reel>
DTSGMW-66: 2000 pcs
DTSMW-68, 66: 2000 pcs
DTSMW-69, 65: 1900 pcs
DTSMW-67, 64: 900 pcs
DTSMW-677: 650 pcs

TACT SWITCH

DTSGMW-66

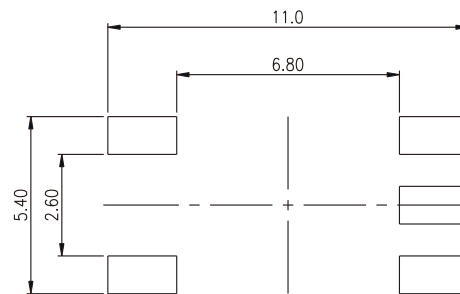
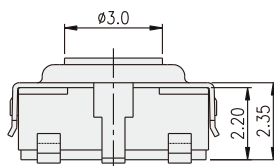
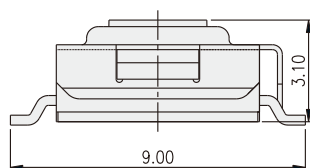
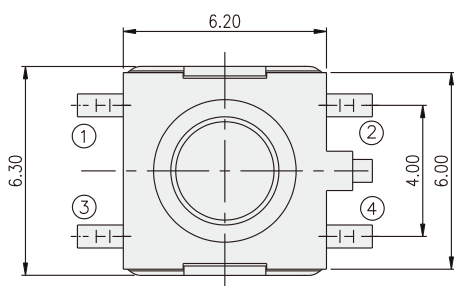

P.C.B. LAYOUT

TACT SWITCH
DTS(G)MW-6 SERIES

6x6 Gull-Wing SMT
 Washable Type



DTSMW-68

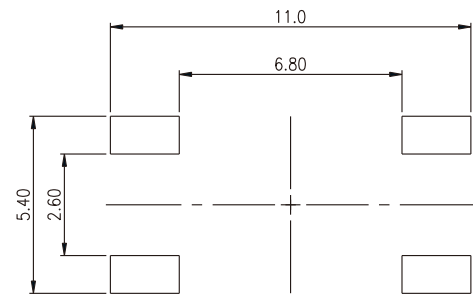
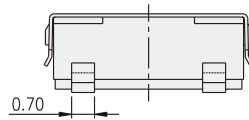
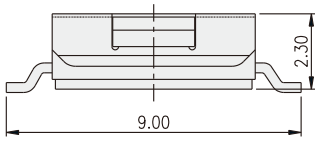
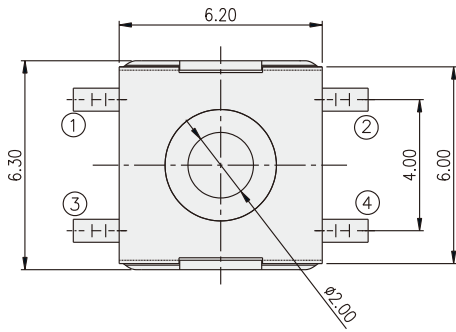

P.C.B. LAYOUT

TACT SWITCH

DTSMW-6 □

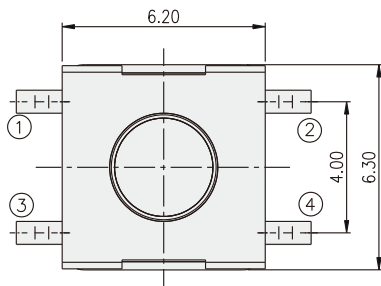

PART NO.	H
DTSMW-64	4.50
DTSMW-65	3.50
DTSMW-67	5.20
DTSMW-69	3.80
DTSMW-677	7.30

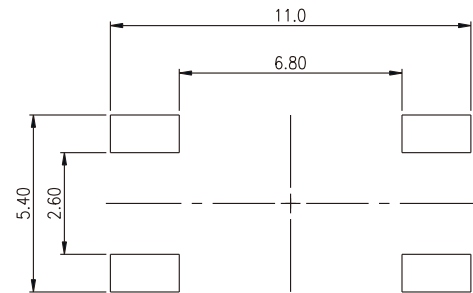
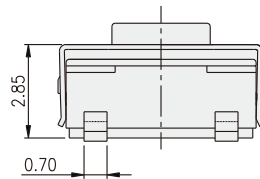
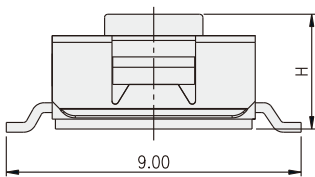

P.C.B. LAYOUT