

Features

- BUILT-IN CURRENT LIMITING RESISTOR FOR DIRECT APPLICATION OF DIFFERENT ACROSS CURRENT.
- LONG LIFE.
- LOW CURRENT, POWER SAVINGS.
- LOW MAINTENANCE.
- DIFFERENT COLOR AVAILABLE.
- SOLID STATE, HIGH VIBRATION RESISTANT.
- 12V INTERNAL RESISTOR

Description

The Super Bright Yellow source color devices are made with DH InGaAlP on GaAs substrate Light Emitting Diode.

Package Dimensions

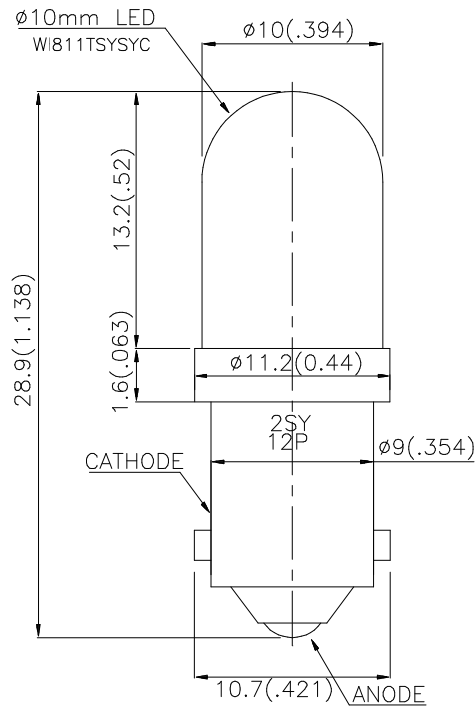

Notes:

1. All dimensions are in millimeters (inches).
2. Tolerance is ± 0.25 (0.01") unless otherwise noted.
3. Specifications are subjected to change without notice.

Selection Guide

| Part No. | Dice | Lens Type | Iv (mcd) V=12V | | Viewing Angle |
|-----------------|-------------------------------|-------------|-------------------|------|---------------|
| | | | Min. | Typ. | θ1/2 |
| BLB102SYC-12V-P | SUPER BRIGHT YELLOW (InGaAlP) | WATER CLEAR | 480 | 1200 | 40° |

Note:

1. θ1/2 is the angle from optical centerline where the luminous intensity is 1/2 the optical centerline value.

Electrical / Optical Characteristics at T_A=25°C

| Symbol | Parameter | Device | Typ. | Max. | Units | Test Conditions |
|-------------------|--------------------------|---------------------|------|------|-------|---------------------------|
| λ _{peak} | Peak Wavelength | Super Bright Yellow | 590 | - | nm | V _F =12V |
| λ _D | Dominate Wavelength | Super Bright Yellow | 588 | - | nm | V _F =12V |
| Δλ _{1/2} | Spectral Line Half-width | Super Bright Yellow | 28 | - | nm | V _F =12V |
| I _F | Forward Current | Super Bright Yellow | 19 | 25 | mA | V _F =12V |
| C | Capacitance | Super Bright Yellow | 25 | - | pF | V _F =0V;f=1MHz |
| I _R | Reverse Current | Super Bright Yellow | - | 10 | uA | V _R = 5V |

Absolute Maximum Ratings at T_A=25°C

| Parameter | Super Bright Yellow | Units |
|-----------------------|---------------------|-------|
| Power Dissipation | 300 | mW |
| Forward Voltage | 14 | V |
| Reverse Voltage | 5 | V |
| Operating Temperature | -40°C To +70°C | |
| Storage Temperature | -40°C To +85°C | |

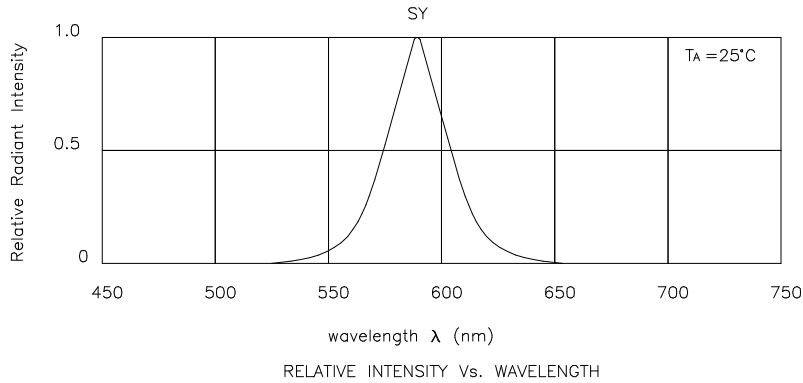

Super Bright Yellow

BLB102SYC-12V-P

